



Anvi RESIDENCY

Ambajim - Fatorda

ANVI RESIDENCY is a residential project of 11 One BHK Apartments, with each apartment equipped with all the necessary facilities. The project amenities include lift, underground water sump, gated compound and individual stilt parking space. It is located in tranquil environment and peaceful neighborhood with all the major public amenities like bus services, schools, convenient stores and other required facilities available in close vicinity, making it Ideal for the first home buyers.



RERA Reg no- PRGO04180104. For more information visit www.rera.goa.gov.in



OFFICE ADDRESS

SHOP NO. 4, SAPANA BARRIER,
BORDA, MARGAO, GOA - 403602

MOBILE

+91 7972539874
+91 9822123146

FLOOR PLANS

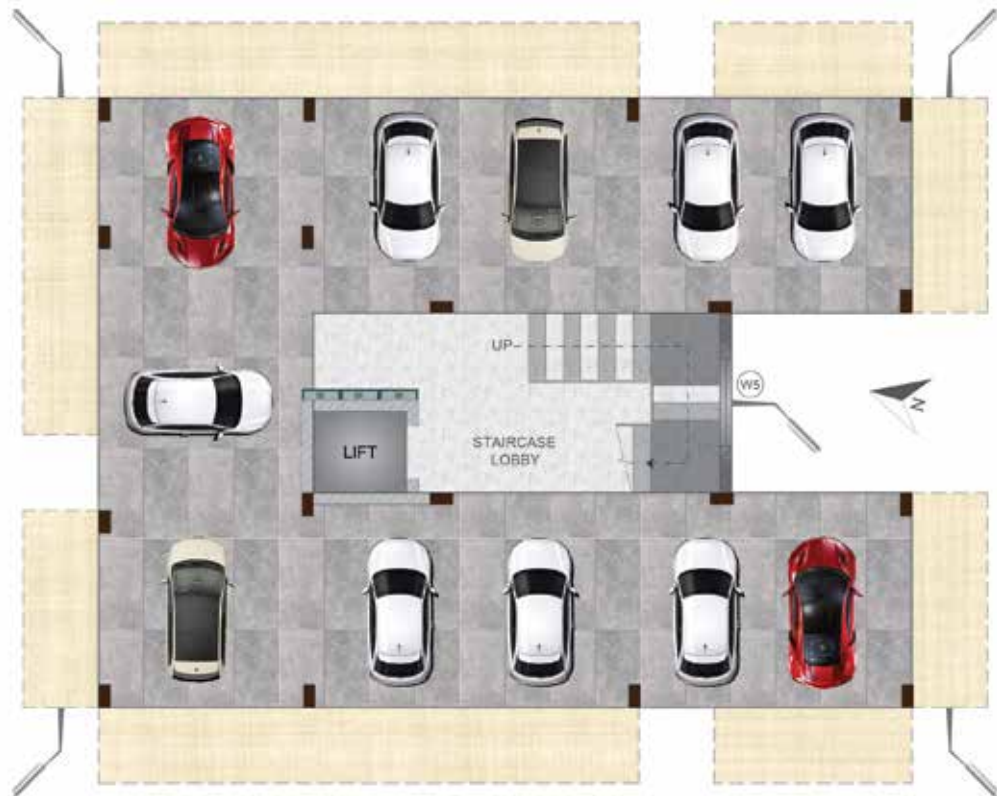

STILT FLOOR PLAN



UPPER GR, 1st & 2nd FLOOR PLAN

OFFICE ADDRESS

SHOP NO. 4, SAPANA BARRIER,
BORDA, MARGAO, GOA - 403602

EMAIL

RAYCONBUILDERS@GMAIL.COM
WWW.RAYCONBUILDERS.COM

MOBILE

+91 7972539874
+91 9822123146





3rd FLOOR PLAN

AREA DETAILS

FLAT NUMBER	UG1, UG3, F1, F3, S1, S3	UG2, F2, S2
CARPET AREA	33.33 SQ.MTS.	33.33 SQ.MTS.
EXCLUSIVE BALCONY AREA	21.06 SQ.MTS.	25.79 SQ.MTS.
TOTAL BUILT UP AREA	63.99 SQ.MTS.	68.72 SQ.MTS.
FLAT NUMBER	T1	T2
CARPET AREA	33.33 SQ.MTS.	37.29 SQ.MTS.
EXCLUSIVE BALCONY AREA	21.53 SQ.MTS.	26.15 SQ.MTS.
TOTAL BUILT UP AREA	64.83 SQ.MTS.	72.90 SQ.MTS.
EXCLUSIVE TERRACE AREA	20.52 SQ.MTS.	28.77 SQ.MTS.

OFFICE ADDRESS

SHOP NO. 4, SAPANA BARRIER,
BORDA, MARGAO, GOA - 403602

EMAIL

RAYCONBUILDERS@GMAIL.COM
WWW.RAYCONBUILDERS.COM

MOBILE

+91 7972539874
+91 9822123146



SPECIFICATIONS

STRUCTURE - RCC framed structure using M20 Grade of concrete.

WALLS - External walls shall be 20 cm C.C./laterite stones and internal walls will be single bricks.

DOORS & WINDOWS - All doors shutters will be provided with good quality Flush doors painted or polished on both sides. All windows shall be aluminium powder coated sliding type. French doors shall be made in Aluminium Sliding Type.

PLASTER & PAINT - External Paint in Ace or equivalent weather shield paint & Internal in tractor emulsion or equivalent.

ROOFING - R.C.C. slab with water proofing, covered with Mangalore Tiles.

FLOORING - All Internal flooring shall be provided with vitrified tiles. Staircase block will be in Natural Stone.

TOILET BLOCKS - Toilet blocks shall consist of E.W.C., wash basin, shower rose and tap with hot and cold water arrangement. All sanitaryware shall be provided in white colour. All toilets and baths shall be provided with glazed ceramic tiles dado with ceramic tiles flooring.

KITCHEN - Kitchen platform shall be provided with granite slab over khadappa frame with stainless steel sink with dado of glazed ceramic tiles upto the height of 60cm.

ELECTRICAL - 3-phase Electrical connection with concealed wiring, multiple light points, AC point in bedroom, TV and telephone points in living room, washing machine, water purifier.

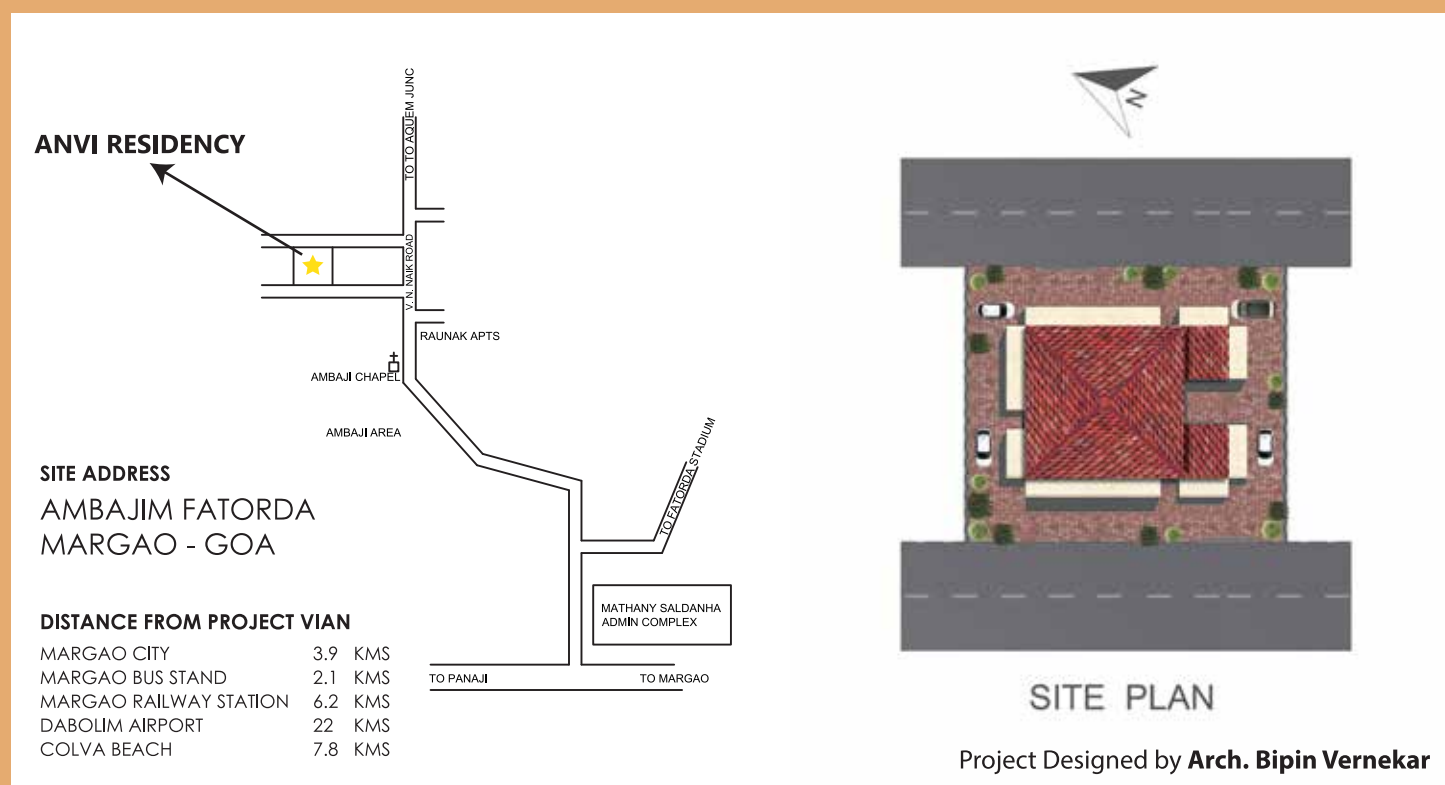

Disclaimer: The images shown in the brochure are pictorial conceptualization. The information contained in this brochure is subject to change as may be required by the authorities or the company and cannot form part of an offer or contract. It is an attempt to replicate the project, however, the actual may differ. Home furnishings, furniture, gadgets and cars are not a part of our offering. The information and contents provided herein are subject to change within the provisions of Act and norms. Specifications shall be as per application form and agreement for sale. The areas shown in the floor plans may vary marginally during construction. Please read and pursue the terms and conditions of Application form/Agreement for sale as well as sanctions, permissions and clearances before tendering your booking.

RERA Reg no- PRGO04180104. For more information visit www.rera.goa.gov.in

OFFICE ADDRESS

SHOP NO. 4, SAPANA BARRIER,
BORDA, MARGAO, GOA - 403602

EMAIL

RAYCONBUILDERS@GMAIL.COM
WWW.RAYCONBUILDERS.COM

MOBILE

+91 7972539874
+91 9822123146

<https://facebook.com/rayconbuilders/>

